



# SLIDING DOOR

ALL-GLASS | ALUMINIUM  
WOODEN | GLASS DESIGN

Sliding doors are popular for their minimalist look, which does not disturb the space in any way and are **practical when placed next to the partition**.

An option of our glass doors in an aluminium frame achieves above-standard acoustic **soundproofing of 27 dB**.

“Wherever it’s needed to maintain the best possible passageway without door leaves in the space.”

Orraine J. Williams | R&D Director



## ALL-GLASS SLIDING GD10 S

### TECHNICAL SPECIFICATIONS:

Description:	interior sliding door
Variant:	single-leafed / double-leafed
Opening:	manual   automatic
Soundproofing Rw:	up to 23 dB
Material:	tempered glass   LIKO-Glass®
Anchoring:	ceiling   partition

### LEAF DIMENSIONS:

Standard:	960 × 2,155 mm
Maximal:	1,200 × 3,000 mm
Thickness:	10 mm (depending on the type of glass)

### VERTICAL SECTION

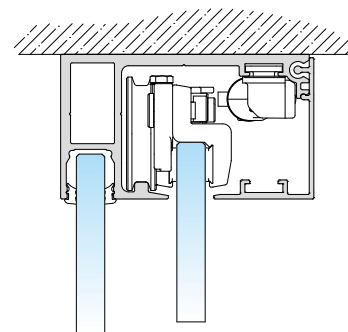

## SLIDING ALUMINIUM AD S

### TECHNICAL SPECIFICATIONS:

Description:	interior sliding door
Variant:	single-leafed / double-leafed
Opening:	manual   automatic
Výplň:	solid   glazed
Soundproofing Rw:	27 dB
Material:	al. frame   tempered glass   LIKO-Glass®
Anchoring:	ceiling   partition

### LEAF DIMENSIONS:

Standard:	960 × 2,155 mm
Maximal:	1,200 × 3,000 mm
Thickness:	40 mm

### VERTICAL SECTION

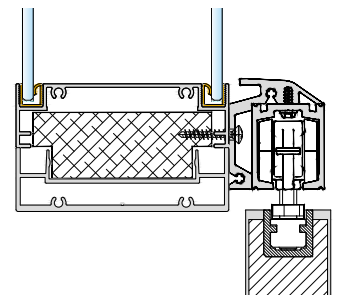

## SLIDING WOODEN WD40 S

### TECHNICAL SPECIFICATIONS:

Description:	interior sliding door
Variant:	single-leafed / double-leafed
Opening:	manual
Filling:	solid   partially glazed
Soundproofing Rw:	27 dB
Material:	LTD   veneer   varnished MDF   HPL
Anchoring:	ceiling   partition

### LEAF DIMENSIONS:

Standard:	960 × 2,155 mm
Maximal:	1,200 × 3,000 mm
Thickness:	40 mm

### VERTICAL SECTION

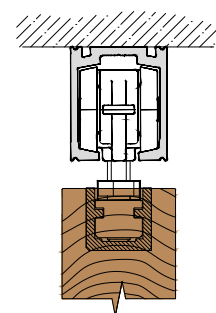

## SLIDING GLASS DESIGN

### TECHNICAL SPECIFICATIONS:

Description:	interior sliding door
Variant:	single-leafed / double-leafed
Opening:	manual   automatic
Filling:	aluminum frame behind the glass panel
Soundproofing Rw:	27 dB
Material:	hidden aluminum frame   tempered glass   LIKO-Glass®
Anchoring:	ceiling   partition

### LEAF DIMENSIONS:

Standard:	960 × 2,155 mm
Maximal:	1,200 × 3,000 mm
Thickness:	48 mm

### VERTICAL SECTION

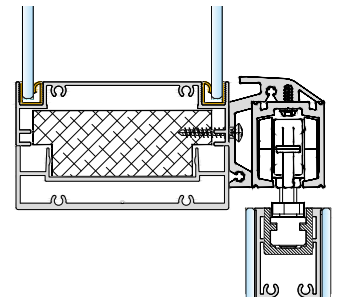

## DETAIL OF DOOR FRAMES



Door frame for systems Micra II | Omega | RAVA  
leaf thickness 10, 12 mm (glass) | 40 mm (wooden)



Door frame for systems Micra I  
leaf thickness 10, 12 mm (glass) | 40 mm (wooden)

## VARIANTS OF DOOR LEAVES

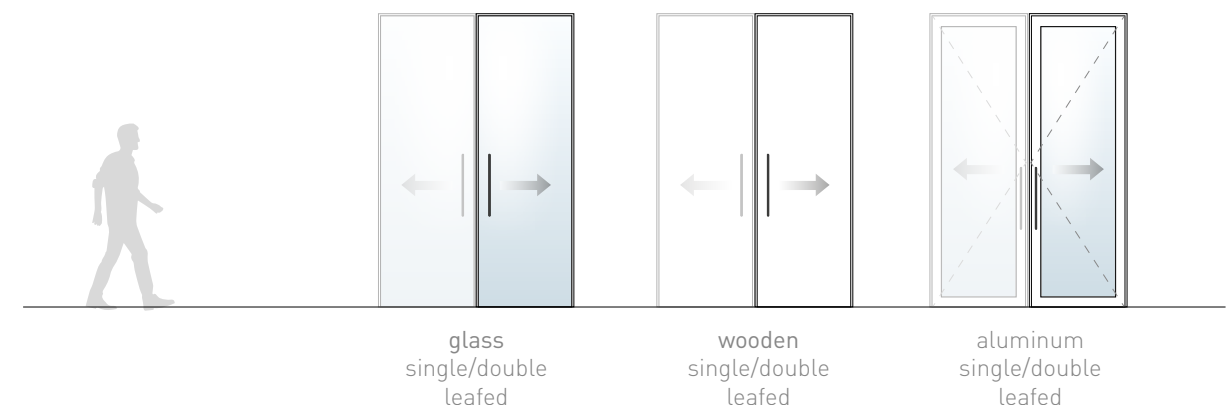





### Headquarters:

LIKO-S, a. s.  
U Splavu 1419  
684 01 Slavkov u Brna  
Czech Republic

+420 5 44 22 11 11 | [info@liko-s.com](mailto:info@liko-s.com)

[www.liko-partitions.com](http://www.liko-partitions.com)

Become one of our fans and be part of the story...



FACEBOOK



YOUTUBE



LINKEDIN